

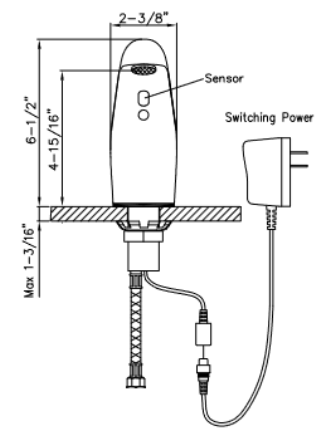
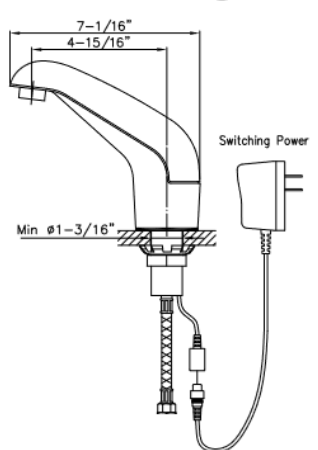

| | | | | | | |
|----------|--|------|--|-----|-----------|--|
| PROJECT | | REF | | REV | ITEM CODE | |
| LOCATION | | DATE | | | PAGE | |

SANITARY WARE SPECIFICATION SHEET

| | | |
|---|--|--|
| <p>Item Descriptions</p> <p>Model</p> <p>Dimensions</p> <p>Finish</p> <p>Manufacturer</p> <p>Source</p> <p>Contact Tel/Fax</p> <p>E-mail</p> <p>Website</p> | <p>Hydrotek (USA) Chrome plated brass handwashing sensor faucet for cold water; operated in AC Supply; top access replacement of batteries; 0.5 GPM vandal resistant aerator</p> <p>H-5000E</p> <p>L125 x W60 x H165 mm</p> <p>Chrome Plated</p> <p>Taiwan</p> <p>Ka Shing Enterprises (H.K) Limited Mr. Ivan Lau / Mr. GilmanYuen</p> <p>(852) 2628-0661 / (852) 2490-2700 kashing.project@gmail.com www.kashingehk.com</p> | <p>Illustration/ Drawing</p>    |
| <p>Product Details</p> <p>The 5000E Series faucet is an elegant piston operated sensory faucet that provides a vandal resistant, no touch lavatory solution that promotes better hygiene and energy savings. Designed to be easy to install and maintain, all major faucet components are encased above deck, making for easier access. The sensor included in this faucet is self adapting, meaning manual adjustments are not necessary and the innovative sensor placement eliminates ambient reflectivity issues.</p> <ul style="list-style-type: none"> ● Standard Plug - in: -Input AC 240V 60Hz ● (UL/CSA) -Output DC 7.5V,0.8A/Class 2 ● Power Cable: -Armored, vandal resistant ● Optional Multi-Unlit Adapter: -Serves up to 10 faucets ● (UL/CSA) -Input AC240V, Output DC 7.5V,3A <p>Vandal-resistant faucet body with chrome plated, solid metal construction. Faucet design allows for quick, simple installation. Clam shell design allows quick "above the deck" access to all major faucet component parts. Slow closing solenoid valve provides reliable and smooth operation without water hammer. Available in AC powered or battery powered versions. Unique energy saving design of electronics and solenoid valve for long battery life. Armored, vandal-resistant AC power input cable (AC powered version). Sensor eye positioning eliminates ambient reflectivity issues. "Self-adapting" sensor distance adjustment eliminates the need for manual sensor adjustments. 30 second time-out features prevents accidental sink overflow. Built-in, replaceable filter screen to reduce maintenance cost. Low battery indicator light (Battery powered versions). Unique electronic control module design allows for faucet electronic component diagnostics. Standard 0.5 GPM vandal resistant aerator. 0.35, 1.5, & 2.2 GPM flow control also available. Single-hole deck mounting with optional 4" and 8" cover plate for vandal resistant three point anchoring.</p> | | |

Note:

* All information of the above is for the reference only. No prior notice is made if any changes.



| | | | | | | |
|----------|--|------|--|-----|-----------|--|
| PROJECT | | REF | | REV | ITEM CODE | |
| LOCATION | | DATE | | | PAGE | |

SANITARY WARE SPECIFICATION SHEET

| No | Description | Part Number |
|----|-------------------------|--------------------------------|
| 1 | Solenoid Module | HCE-004 |
| 2 | Solenoid Coil | HCE-019 |
| 3 | Solenoid Assembly | HCE-194 |
| 4 | Control Module Assembly | HCE-018A (AC) HCE-018B (DC) |
| 5 | Aerator Connector | HCE-006 |
| 6 | Copper Supply Tube | HCE-016 |
| 7 | Rubber Gasket | HCE-022 |
| 8 | Mounting Nut & Washer | HCE-021 |

Note:

* All information of the above is for the reference only. No prior notice is made if any changes.



| | | | | | | |
|----------|--|------|--|-----|-----------|--|
| PROJECT | | REF | | REV | ITEM CODE | |
| LOCATION | | DATE | | | PAGE | |

SANITARY WARE SPECIFICATION SHEET

HCE-194 Solenoid Valve Assembly Replacement

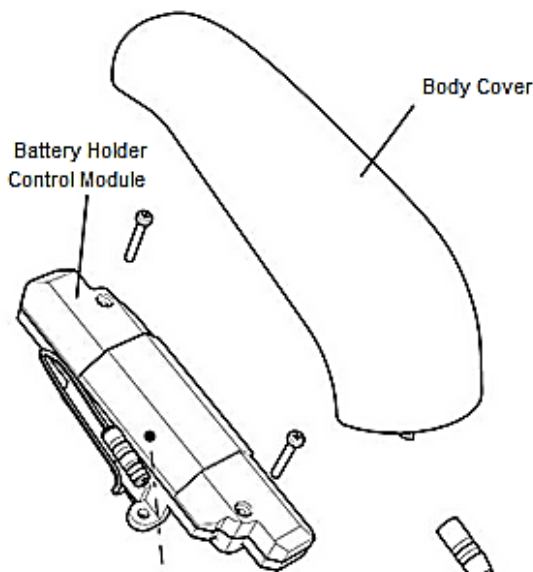

1. Remove faucet Body Cover.
2. Remove batteries (battery powered faucets) or unplug power adapter (AC powered faucets).
3. Loosen and remove the Battery Holder/Control Module, making sure to disconnect all connectors.
4. Unscrew and remove the Solenoid Coil from the Solenoid Valve Module.
5. Completely loosen the four screws securing the Solenoid Valve Module. List the Solenoid Valve Module from the faucet.
6. Install the new Solenoid Valve Module and reassemble the faucet in reverse order. *NOTE: When installing the Solenoid Coil to the Solenoid Valve Module, DO NOT over-tighten. Fit should be snug.*

CONTROL MODULE (P.C. BOARD) REPLACEMENT

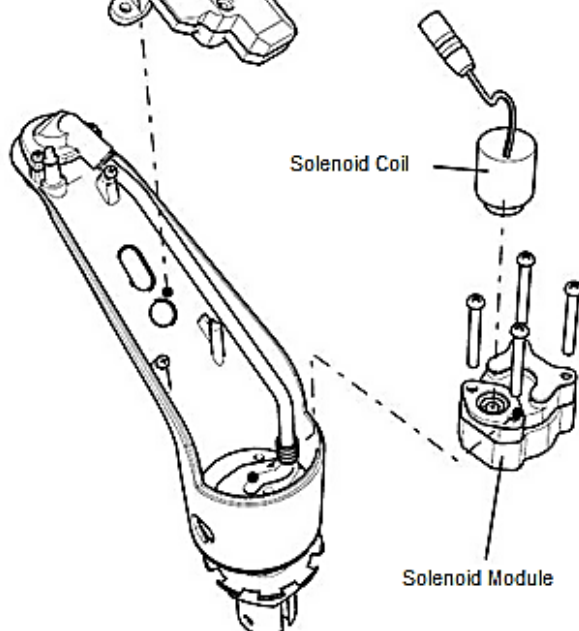

1. Remove faucet Body Cover.
2. Remove batteries (battery powered faucets) or unplug power adapter (AC powered faucets).
3. Unplug the Battery Holder/Control Module connector.
4. Loosen the two screws holding the Battery Holder/Control Module and remove it.
5. Install the new Battery Holder/Control Module ensuring the sensor eye is fitted correctly to the faucet body.

Note:

* All information of the above is for the reference only. No prior notice is made if any changes.



水務署
Water Supplies Department

總部 Headquarters

香港灣仔告士打道七號入境事務大樓 48 樓

48/F, Immigration Tower, 7 Gloucester Road, Wan Chai, Hong Kong

本署檔號 : (4) in WSD 3321/2020 T/J(1594/2020)
Our ref.
來函檔號 :
Your ref.

電話 :
Tel.
傳真 : 2824 0578
Fax.

21 January 2021



**Approval of "HYDROTEK" Sensor Taps
(General Acceptance No. C20210049)**

Your letters ref. 490/20 and 555/20 dated 4 December 2020 and 4 January 2021 respectively refer.

Having considered the test report ref. RHCF025 issued on 2 December 2020 by Ideal Test Consultants Ltd., this Authority accepts that the fittings described below comply with, and their use when correctly installed does not contravene, the Waterworks Ordinance and Regulations.

Name of Manufacturer: Hydrotek Corporation

Country of Origin: Taiwan, China

Brand: Hydrotek

Details of Fitting: 3/8" Deck mounted sensor tap

Model: HB-5000E and H-5000E

Body Markings: **Hydrotek**

Expiry Date: 11 November 2025



This Authority hereby permits the use of the above fittings in fresh water plumbing systems subject to full adherence to Waterworks installation requirements. In particular, you are required to draw your customers' attention to the following requirement-

"A stop cock or gate valve must be installed at the upstream of the fittings for manual isolation of water supply." AND

"The main voltage operated sensor valve should comply with the electricity safety regulation for applications in bathroom, toilet etc."

A condition of this acceptance is that the fittings to be installed shall be replicas of the samples as certified by the testing agent mentioned above and without modifications. This acceptance may be withdrawn at any time if the standard of the fittings installed fails to meet that of the approved samples or if the fittings are found to be unsuitable for use in fresh water plumbing systems.

This acceptance is only applicable to the main body of the fittings, unless otherwise specified.

For the use of the fittings in any project, the General Acceptance Number of this letter must be quoted as a means of identification of acceptance of the fittings by this Authority.

Should you have any enquiries, please contact our Engineer Mr. Terry KUNG at tel. no. 3583 4086.

Yours faithfully,



(CHAN Chung-kun)

for Director of Water Supplies

Encl.

c.c. WSD 3321/1/82] - without catalogue
ME/MC] - with soft copy only

General Acceptance No. C20210049