

SANITARY WARE SPECIFICATION SHEET

Model: DJE0010CS

Descriptions: Mediclinics (Spain) recessed liquid soap dispenser, stainless steel AISI 304, satin finish 1.4 L capacity

Dimensions: L260 x W162 x H152 mm

Material : Stainless Steel

Manufacturer: Mediclinics, S.A. (Spain)

Finish : Satin Finish



Dimensions

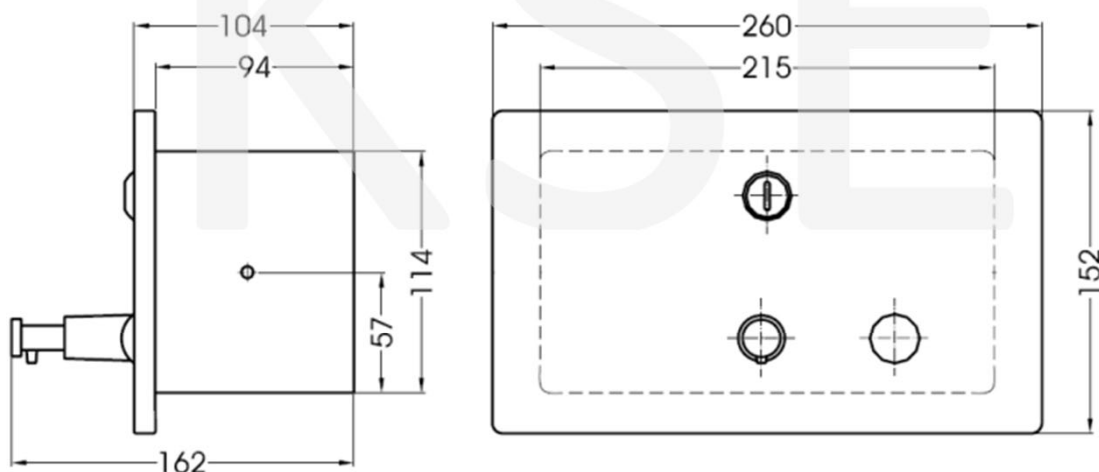

Dimensions $\pm 4\%$

* All information of the above is for the reference only. No prior notice is made if any changes.



Ka Shing Enterprise (H.K.) Ltd.

ROOM 1706 NEW TERRITORIES TSUEN WAN HO LIK CENTRE, 66A SHA TSUI ROAD
Tel:26280661 Fax: 24902700
Email: project@kashingehk.com
Website: www.kashingehk.com

Ivan / Horace 26280661

E/ project@kashingehk.com

W/ <https://www.kashingehk.com/>

General Description

- Recessed liquid soap dispenser with inner plastic tank, push-button operated of 1.4 L capacity and manufactured in stainless steel AISI 304, 0.8 mm thick.
- Available in satin finish, this soap dispenser model has a functional, robust and trendy design that matches the new range of Mediclinics bathroom accessories. This allows this soap dispenser to blend into any space perfectly.
- Maximum robustness and vandal resistant.
- Suitable for high traffic facilities and for public use.
- Dispenses liquid soap or hand sanitizing gels.
- It is recommended to use liquid soap or hand sanitizing gel with the following characteristics:
 - Maximum alcohol content of 80%
 - Density between 0.9 and 1.35 kg/dm³
 - Viscosity between 500 and 2,500 cps.**It does not support soaps that contain methanol, chlorine or solid or abrasive particles.**
- Lock with a supplied special key.

Components & materials

- **FRONTAL PART:** one-piece part made of stainless steel AISI 304, satin finish, 0.8 mm thick. It incorporates a level display in the front part that constantly indicates the level of soap available inside the soap dispenser.
- **INNER TANK:** made of thermoplastic to prevent oxidation.
- **PUSH BUTTON:** made of chrome brass.
- **VALVE:** Anti-drip valve.

Technical Specifications

Dimensions	260x152x162 mm
Body thickness	0.8 mm
Net weight	1.4 Kg
Quantity dispensed per pump	1.1 ml
Capacity	1.4 ml

MOUNTING TEMPLATE

Recommended installation height: between 15 and 20 cm above countertop.

Fix the soap dispenser inside the hole in the wall using the supplied stainless steel plugs and screws through the holes indicated by an "S" in the following figure:

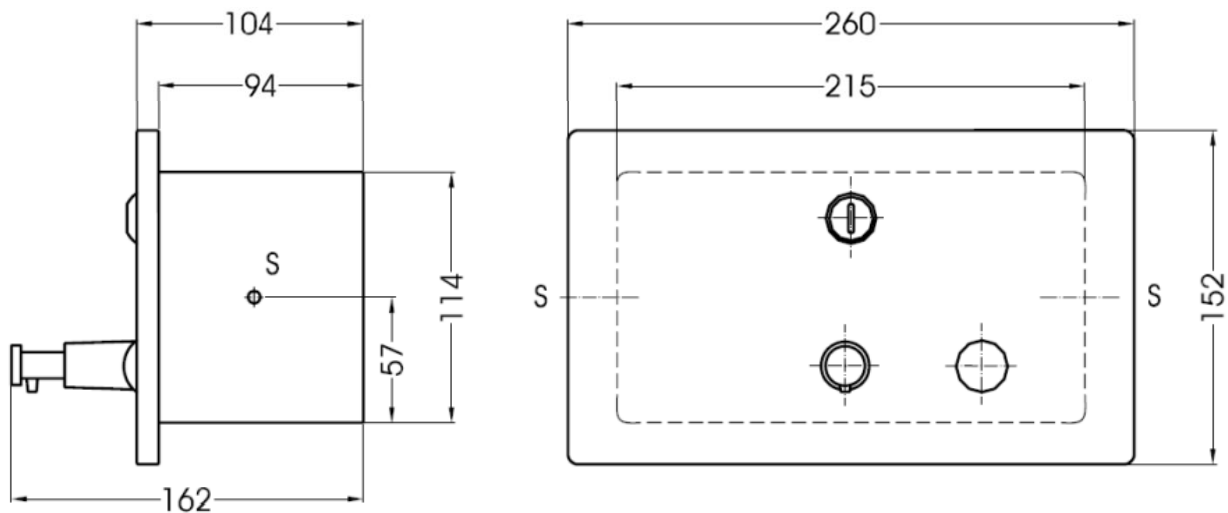

Ka Shing Enterprise (H.K.) Ltd.

ROOM 1706 NEW TERRITORIES TSUEN WAN HO LIK CENTRE, 66A SHA TSUI ROAD
Tel:26280661 Fax: 24902700
Email: project@kashingehk.com
Website: www.kashingehk.com

Ivan / Horace 26280661

E/ project@kashingehk.com

W/ <https://www.kashingehk.com/>