

SANITARY WARE SPECIFICATION SHEET

Model: CP0016VCSB

Descriptions: Casatino (PRC) Horizontal wall mounted polyethylene baby changing station, Capacity: Static loads of 15KG with EN 12221 Registration No. NBHL1710016979IP

Dimensions: L540 x W820 x H390 mm

Manufacturer: CASATINO (PRC)

Material: Polyethylene

Finish: Gray

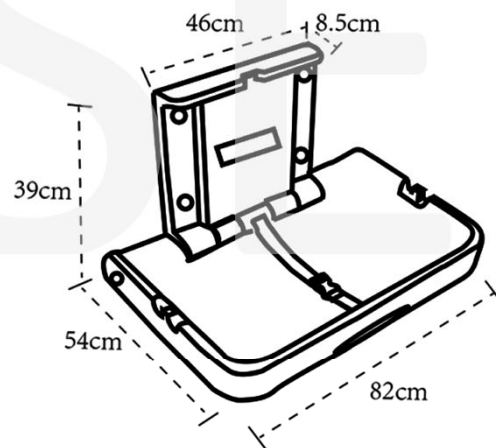
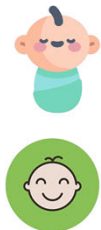

Baby changing station body shall be durable, injection-molded polypropylene. Design of unit shall be surface-mounted. Unit shall be equipped with a pneumatic cylinder for controlled opening and closing of bed. Bed shall be secured to metal mounting chassis with a concealed steel-on-steel hinge. No hinge structure shall be exposed on interior or exterior surfaces. Unit shall have mounting hardware included. regulations when properly installed. Bed shall have smooth concave changing area with a safety strap.

The design and manufacture of products is intended to be compliant with the 2010 ADA Standards for Accessible Design and the 2009 ICC A117.1, Accessible and Usable Buildings and Facilities. Unit shall conform to ASTM F2285-04(16) Standard Safety Performance Specification for Diaper Changing Tables for Commercial Use, ANSI Z535.4 Product Safety Signs and Labels, EN 12221:2008+A1: 2013. Unit shall have a built-in Liner Dispenser for use with 3-ply chemical free biodegradable bed liners, instructional graphics and safety.

* All information of the above is for the reference only. No prior notice is made if any changes.



Ka Shing Enterprise (H.K.) Ltd.

ROOM 1706 NEW TERRITORIES TSUEN WAN HO LIK CENTRE, 66A SHA TSUI ROAD
Tel: 26280661 Fax: 24902700
Email: project@kashingehk.com
Website: www.kashingehk.com

Ivan / Horace 26280661

E/ project@kashingehk.com

W/ <https://www.kashingehk.com/>



Baby changing stations

Installation instructions

Product specification

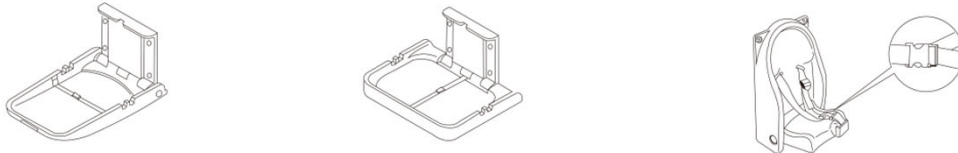

Installation method

1. Rack 90cm high from the ground, drill five holes according to the size mark on the instruction.(fig1)
2. Take out the fittings,install the expansion pipe into the holes.(fig2)
3. Take out one screw to fix it into the middle hole (18.5CM from both right & left),screw out one centimeter, Hang the baby change station on the screw.(fig3)
4. According to the size mark on the instruction,fix the machine with another four screws.(fig4)
5. Cover the hole case to finish the installation.(fig5)

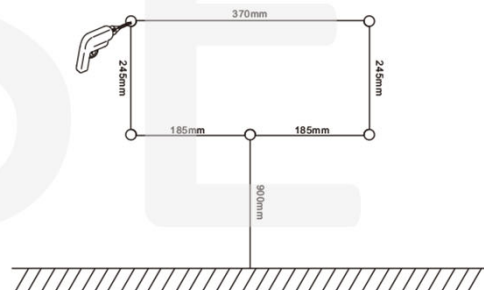

FIG. 1

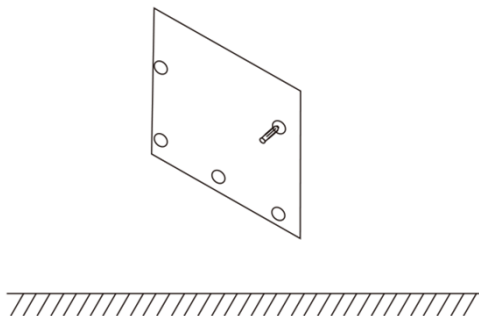

FIG. 2

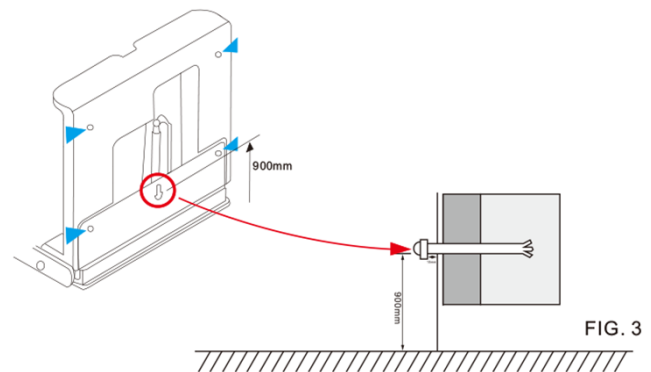

FIG. 3



Ka Shing Enterprise (H.K.) Ltd.

ROOM 1706 NEW TERRITORIES TSUEN WAN HO LIK CENTRE, 66A SHA TSUI ROAD
Tel:26280661 Fax: 24902700
Email: project@kashinghk.com
Website: www.kashinghk.com

Ivan / Horace 26280661

E/ project@kashinghk.com

W/ <https://www.kashinghk.com/>



Baby changing stations

Installation instructions

Product specification

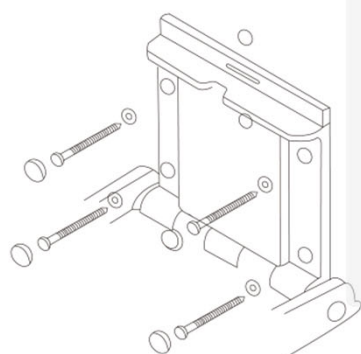
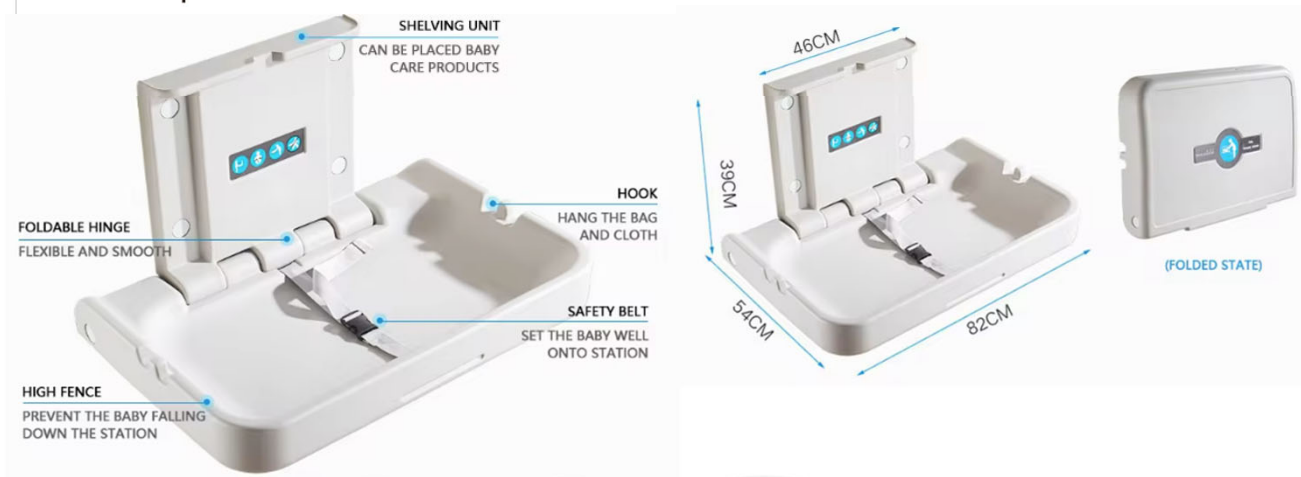

FIG. 4

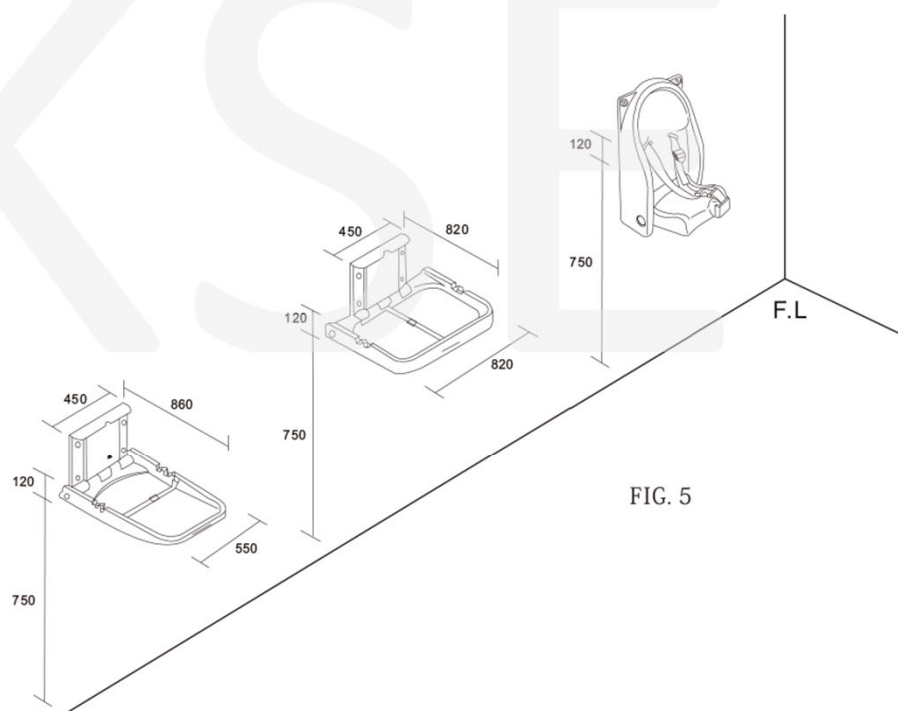

FIG. 5



Ka Shing Enterprise (H.K.) Ltd.

ROOM 1706 NEW TERRITORIES TSUEN WAN HO LIK CENTRE, 66A SHA TSUI ROAD
Tel: 26280661 Fax: 24902700
Email: project@kashinghk.com
Website: www.kashinghk.com

Ivan / Horace 26280661

E/ project@kashinghk.com

W/ <https://www.kashinghk.com/>

Test Conducted:

EN 12221: 2008+A1: 2013 CHANGING UNITS FOR DOMESTIC USE: PART 1: SAFETY REQUIREMENTS; PART 2: TEST METHODS

1. Scope

This part of EN 12221 specifies safety requirements for changing units for domestic use for children with a body weight no more than 15 kg.

EN 12221 only covers the function of the item as a changing unit. If the changing unit can be converted or used as another function it shall comply with other relevant standards, e.g. cots, storage furniture, etc.

The changing unit may be foldable and can be fitted with a child bathtub or other additional items.

Changing pads are only covered by this standard when they form a part of the changing unit.

2. Number of test specimen: 1 Piece of packaged sample

3. Test Result: Details Shown As Following Table:

Clause	Test Method/ Requirement	Rating									
4	General requirements										
4.1	Dimensions The dimension of the changing area shall be at least as defined as follows:	Pass (Type 1)									
	<table border="1"> <thead> <tr> <th>Changing unit type</th> <th>Width</th> <th>Length</th> </tr> </thead> <tbody> <tr> <td>1</td> <td>380mm</td> <td>650mm</td> </tr> <tr> <td>2</td> <td>550mm</td> <td>750mm</td> </tr> </tbody> </table>		Changing unit type	Width	Length	1	380mm	650mm	2	550mm	750mm
	Changing unit type		Width	Length							
1	380mm	650mm									
2	550mm	750mm									
4.2	Materials										
4.2.1	Wood Wood, wood-based materials and materials of vegetable origin shall be free from decay and insect attack.	N/A									
4.2.2	Surfaces and materials Any coating of paint, varnish, lacquer or similar substances and parts consisting of dyed materials, leather, textiles, and plastics materials within the accessibility zone shall be made using products which in their soluble compound do not exceed the following amounts: Antimony : 60 mg/kg Arsenic : 25 mg/kg Barium : 1000 mg/kg Cadmium : 75 mg/kg Chromium : 60 mg/kg Lead : 90 mg/kg Mercury : 60 mg/kg Selenium : 500 mg/kg Where a surface is coated with a multi-layer paint or similar coating, the sample shall be taken down to the base material. The test procedure is defined in EN 71-3.	See Result									



Clause	Test Method/ Requirement	Rating
5.1.1	Entrapment of fingers Within the accessibility zone there shall be no holes, gaps and openings with a width greater than 7 mm and less than 12 mm, unless the depth is less than 10 mm when measured in accordance with EN 12221-2:2008+A1:2013, 5.3.1.	Pass
5.1.2	Entrapment of limbs Within the accessibility zone there shall be no holes, gaps and openings having a width greater than 25 mm and smaller than 45 mm when measured in accordance with EN 12221-2:2008+A1:2013, 5.3.2.	Pass
5.1.3	Entrapment of head, neck and torso	Pass
5.1.3.1	Within the accessibility zone there shall be no hole, gap or opening larger than 65 mm and less than 223 mm when measured in accordance with EN 12221-2:2008+A1:2013, 5.3.3.1.	Pass
5.1.3.2	Within the area 600 mm above the floor to the accessibility zone, see Figure 2, there shall be no hole, gap or opening accessible in normal use that allows the type 1 head probe to pass completely through unless it also allows the type 2 head probe to pass completely through, when tested in accordance with EN 12221-2:2008+A1:2013, 5.3.3.2	Pass
5.1.3.3	V-shaped openings Within the area 200 mm above the floor to the accessibility zone any hole, gap or opening accessible in normal use that allows the type 1 head probe to pass completely through shall not be a V-shaped opening as defined in 3.6 when tested in accordance with EN 12221-2:2008+A1:2013, 5.3.3.3.	N/A
5.1.4*	Cords, strings and other narrow fabrics Cords, strings and other narrow fabrics (e.g. those used for ties) shall have a free length of not more than 220 mm when tested in accordance with EN 12221-2:2008+A1:2013, 5.3.4.	N/A
5.1.5*	Loops Loops shall not have a peripheral dimension greater than 360 mm when tested in accordance with EN 12221-2:2008+A1:2013, 5.3.5.	N/A
5.2	Edges, points and corners Edges and protruding parts accessible in normal use shall be rounded or chamfered and free of burrs. The upper edges of the barriers and the changing surface shall have a radius of not less than 2 mm.	Pass
5.3	Moving parts Changing board flaps are excluded from this requirement, as they are covered by 5.12. When the changing unit is erected ready for use the distance between two parts within the accessibility zone which move relative to each other shall always be less than 5 mm or more than 12 mm throughout the entire movement when tested in accordance with EN 12221-2:2008+A1:2013, 5.4.	Pass



Ka Shing Enterprise (H.K.) Ltd.

ROOM 1706 NEW TERRITORIES TSUEN WAN HO LIK CENTRE, 66A SHA TSUI ROAD
 Tel:26280661 Fax: 24902700
 Email: project@kashingehk.com
 Website: www.kashingehk.com

Ivan / Horace 26280661

E/ project@kashingehk.com

W/ <https://www.kashingehk.com/>